



ANTHONY
MACHINE

PRECISION COMPONENT MACHINING

THE MOST TRUSTED NAME IN PRECISION MACHINING

Precision Made. Quality Driven.

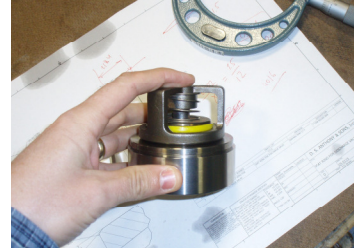
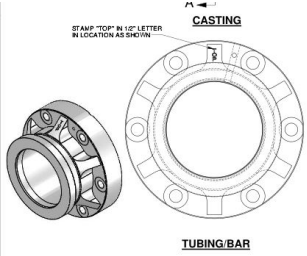

The Anthony Advantage
Offering the industry's best workforce a culture of precision and service, Anthony Machine delivers customer directed outcomes in the quality machining of new and refurbished parts.

At Anthony Machine, we not only believe in this advantage, we design our work practices around it. We know that quality machined parts are necessary to make equipment run right; enabling our customers to do what they do. We understand that we have a responsibility to serve our customers by providing them with the quality parts they need when they need them.

With a culture focused on precision and service, Anthony Machine aims to be our customers' favorite supplier in the quality machining of parts.



In doing so we provide customers with the **Anthony Advantage: Quality Machined Parts that result in measurable benefits to their bottom line.**

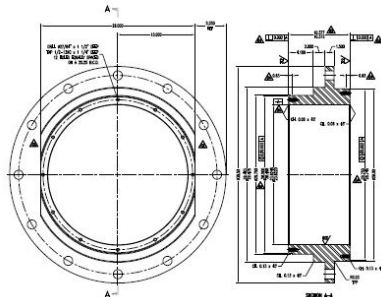

EQUIPMENT CAPACITIES

CNC Lathes: (Up to 51" swing)

CNC Vertical Lathes: (Up to 62" swing)

CNC Vertical Machining Centers: (Up to X-84", Y-39", Z-31")

CNC Horizontal Machining Centers: (Up to X-53.0", Y-51", Z-39")

Manual Lathes: (Up to 40" swing)

Manual Vertical Lathes: (Up to 72" swing)

Manual Horizontal Boring Mill: (Up to X-40", Y-132", Z-50")

Manual Mills: (Capacity up to X-312", Y-56", Z-57")



ISOMETRIC VIEW
SCALE 1:2



Precision machined parts from initial drawing to completed part. Multiple quality control inspections throughout the process.

Best-in-Class Quality Assurance Program

Anthony Machine maintains a stringent Quality Management System in order to meet the demanding needs of our customers' business. Combining 70 years of practical experience with the latest proven procedures, which are strictly adhered to for our new as well as our refurbished parts and equipment.

Our operations conducted under strict policies of ISO 9001:2008 certified Quality Management System.

FOR A QUOTE OR TO TOUR OUR PRECISION MANUFACTURING FACILITY, CONTACT
STEVE FRAUNHOFER (210) 503-6226 EMAIL: sfraunhofer@anthonymachine.com